

Como 2-150 INDOOR SAUNA

INSTALLATION MANUAL

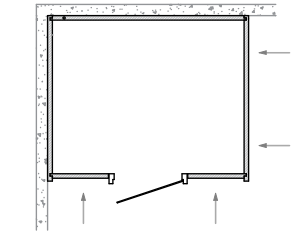

* minimum space required for installation



To place the sauna in a corner, assemble the wall logs first, then push it against the walls.



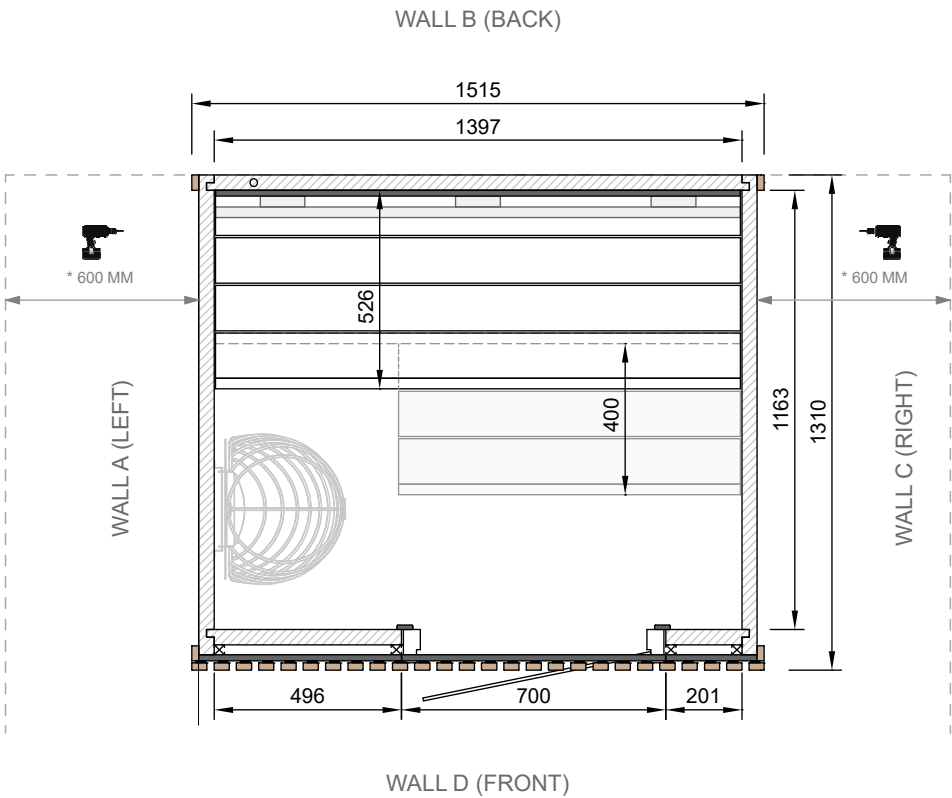



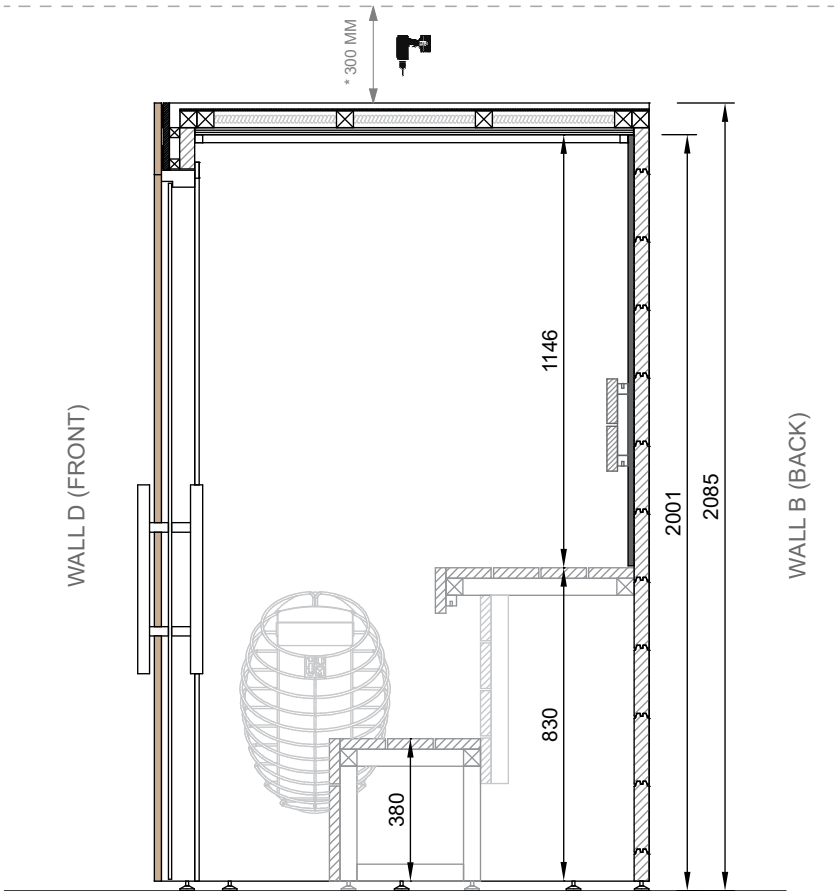



Layout Plan:



Cross Section:



DETAILS LIST - Wall Logs:

Marking	Detail	Note	Length	Pcs.
007	40x188 Wall Log		1437	10+1*
006	40x85 Wall Log		1437	1
008	40x118 Wall Log		1437	1
005	40x118 Wall Log		1437	1
000	40x188 Wall Log	<i>extra side wall logs (use only if necessary)</i>	1297	2*
010	40x188 Wall Log		1270	10
009	40x175 Wall Log		1270	1
011	40x93 Wall Log		1270	1
013	40x188 Wall Log		1270	10
012	40x175 Wall Log		1270	1
014	40x93 Wall Log		1270	1
003	40x188 Wall Log		516	10
001	40x85 Wall Log		516	1
004	40x188 Wall Log		221	10
002	40x85 Wall Log		221	1
	Hitting Block			2

Facade:

P-1	27x27 Vertical post		2060	4
P-2	27x27 Horizontal post		690	2
	19x40 Decorative grooved slats		2060	19+4*
	19x40 Decorative grooved slats		190	11+1*
	Facade panel: LEFT		536 x 2060	1
	Facade panel: RIGHT		241 x 2060	1
	Facade panel: CENTER		698 x 178	1

Ceiling:

	Ceiling element 1		821 x 1241	1
	Ceiling element 2		572 x 1241	1

Doors:

U-1	Glass Door 88x690x1880			1
	Door handle			1
	Screw Cover Caps			8

Moldings, Tapes, Sealing strips:

DI-0	21x21 Ceiling Molding	<i>Cut to length!</i>	~2100	4
UL-1	12x42 Door Molding	<i>Cut to length!</i>	2200	3
	Rubber Sealing Strip	<i>For ceiling elements</i>	2,4 m	1

* Spare parts included for replacement in case of damage or missing components.

DETAILS LIST - Sauna Benches:

Marking	Detail	Note	Length	Pcs.
	Top Bench		526 x 1389	1
	Bottom Bench		400 x 905	1
	Bench Horizontal Support Set 45x45			1
	Bench Side Frame		372 x 350	1
	Bench Skirt		498 x 1389	1
	Backrest		246 x 1389	1

Fasteners and Accesories:

	Adjustable Leg M8x40	+ rubber pads	Ø 38 mm	13
	Plastic Fixing Clips	for decorative slats		84+1*
	Screw 6x13.5	for fixing clips		84+1*
	Screw 4.5x70			70
	Screw 4.5x60			250
	Screw 3.5x50			5
	Lost- Head Nail 40 mm			100
	Ventilation Valve Ø100			1

Optional Extras - If Ordered Additionally:

	Decorative Back Wall Panel		1389 x 1140	1
	LED Lighting Set 1	for top bench		1
	LED Lighting Set 3	for top bench and backrest		1

* Spare parts included for replacement in case of damage or missing components.

Wall Assembly:

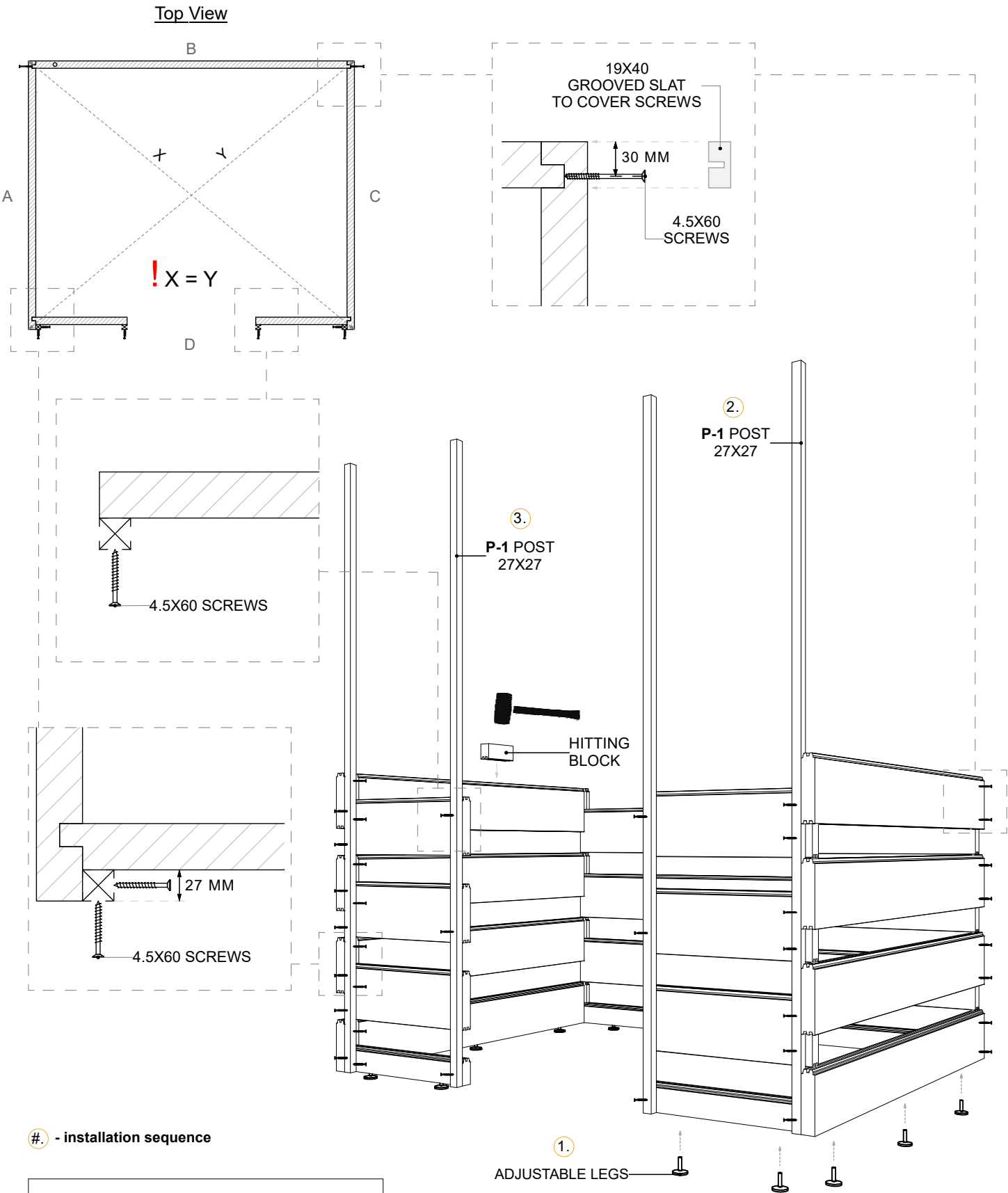

Required Tools:

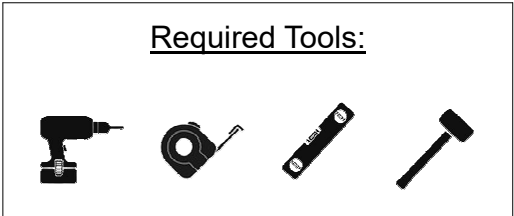

Wall Layout:

Continue stacking the wall logs according to the layout plan.
As you proceed, ensure that the pre-drilled cable conduit drillings are properly aligned.
To make ceiling installation easier, do not install the top wall log on the right wall at this stage.

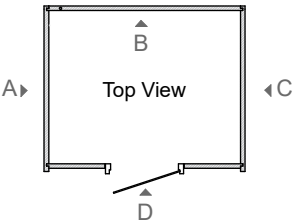

WALL D (FRONT)
VIEW FROM THE OUTSIDE

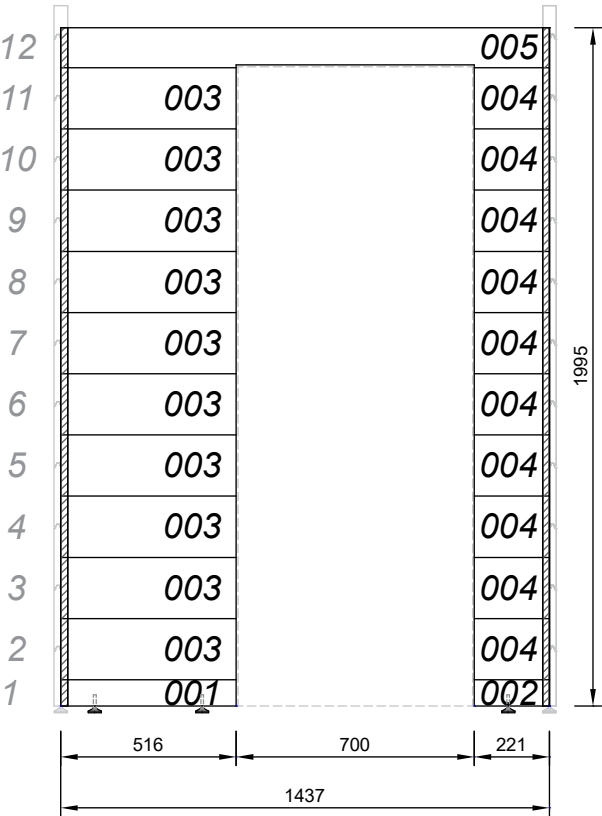

WALL A (LEFT)
VIEW FROM THE OUTSIDE

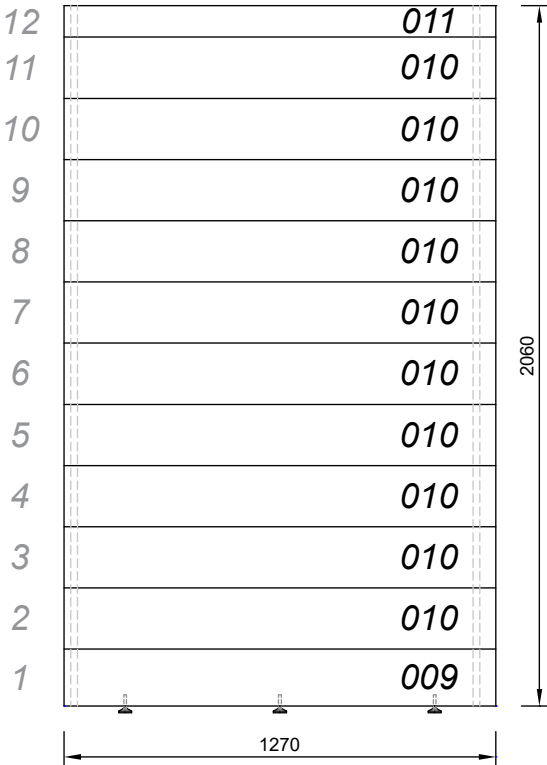

WALL B (BACK)
VIEW FROM THE INSIDE

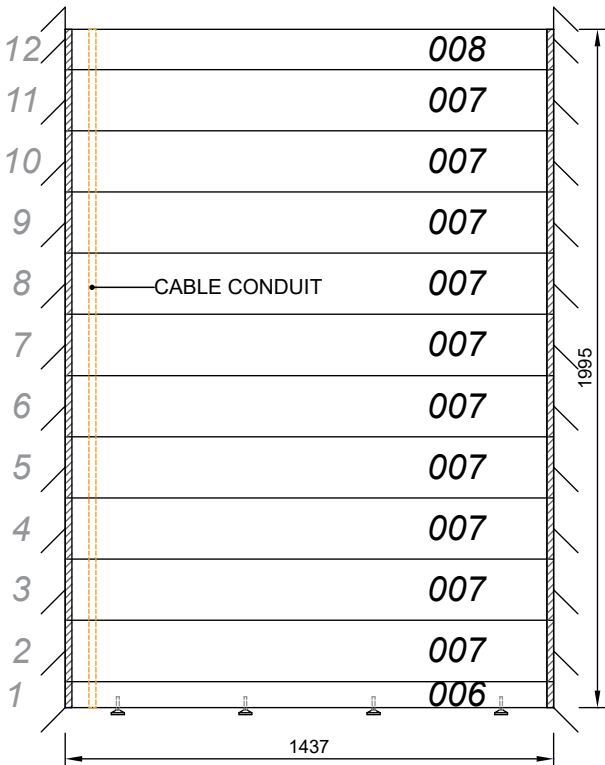

! INSTALL THE LAST WALL LOG
AFTER THE CEILING ELEMENTS
HAVE BEEN FITTED.

WALL C (RIGHT)
VIEW FROM THE OUTSIDE

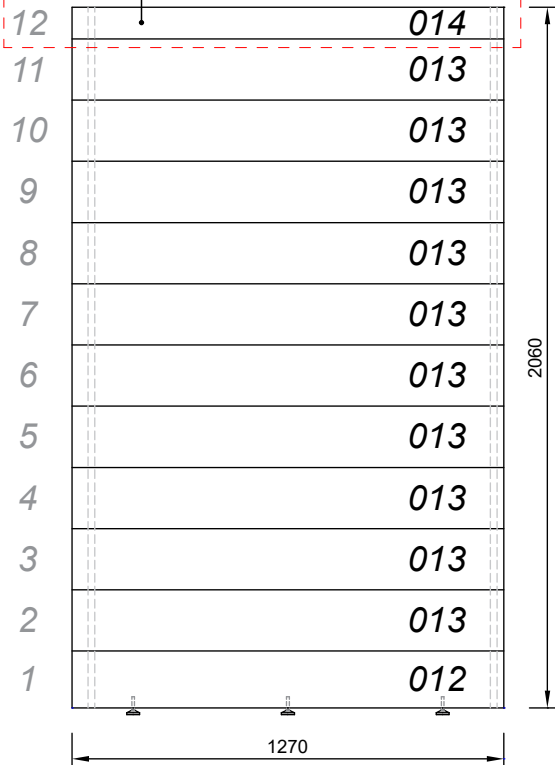

Ceiling Installation and Wiring:

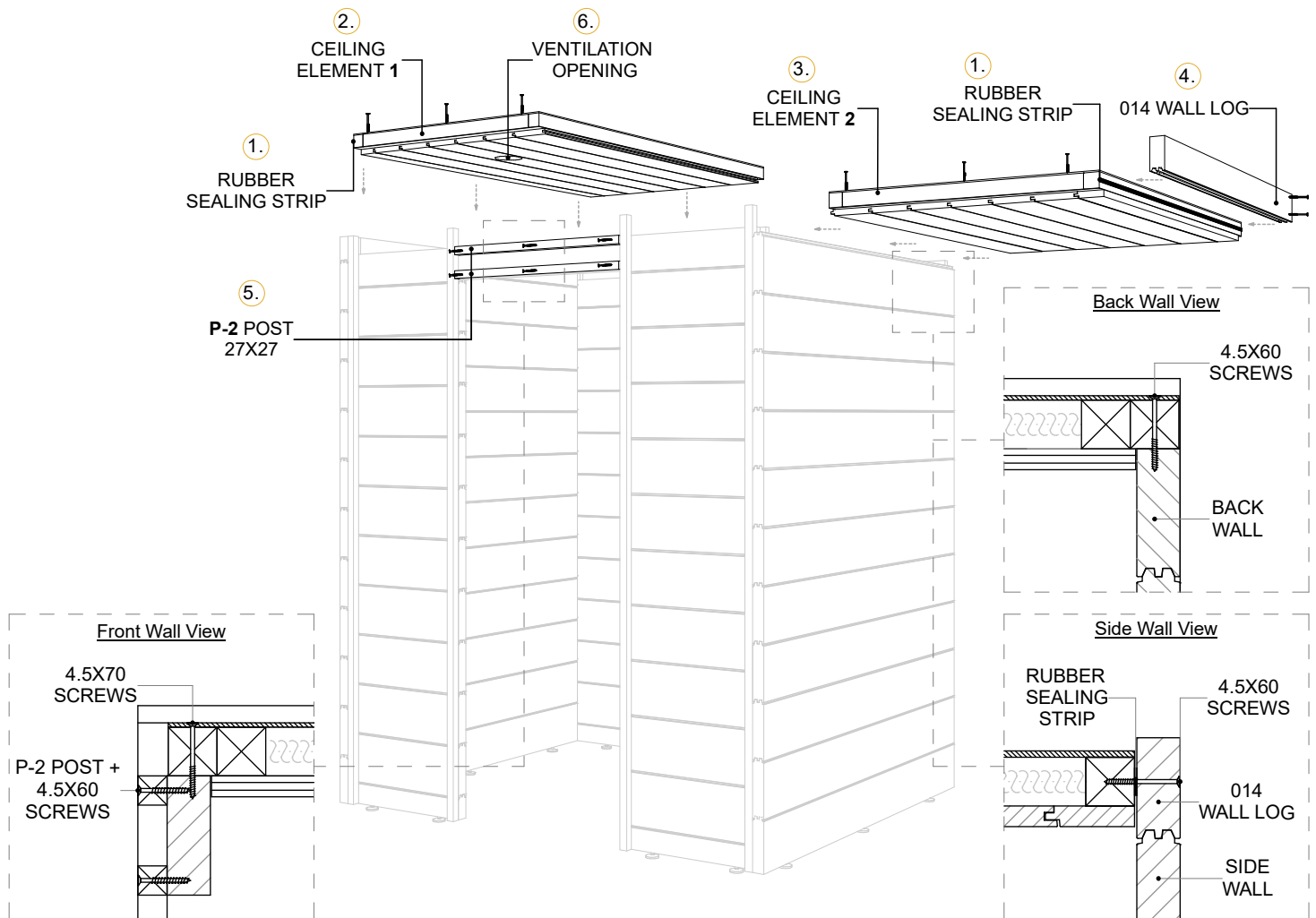

Electrical Wiring:

Choose the preferred side for installing the sauna controller, and plan the placement of the temperature sensors to ensure accurate readings and optimal performance.

Route the electrical wiring for the control panel, sensors and LED lighting under the sauna benches and behind the backrests (if ordered additionally) through the cable conduit, across the ceiling and along the front walls.

! Complete these steps before attaching the facade panels.

Connect the main power cable to the LED lighting wiring in the junction box.

The junction box can be placed on top of the ceiling elements for easy access and concealment, or in any other accessible location depending on site conditions.

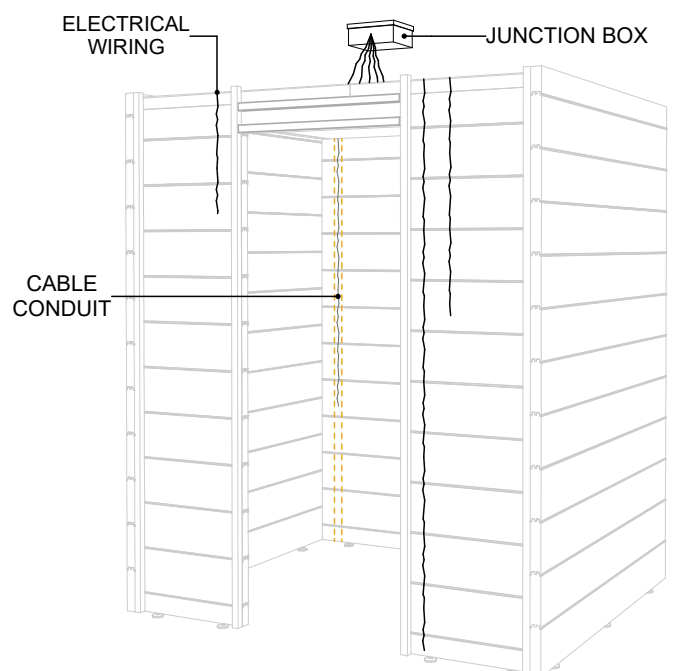

! Electrical installation must be carried out by a certified electrician to ensure safety and compliance with local regulations.

Fixing Clip Mounting Layout:

! Confirm that all electrical conduits, wiring, and associated components are completely installed, tested, and approved in their final locations prior to fixing the facade panels in place.

Attach the fixing clips to the facade panels using 6×3.5 mm screws, following the provided layout.

! Ensure each clip is positioned correctly—the screw placement affects the spacing, so pay close attention to maintain even gaps between the decorative slats.

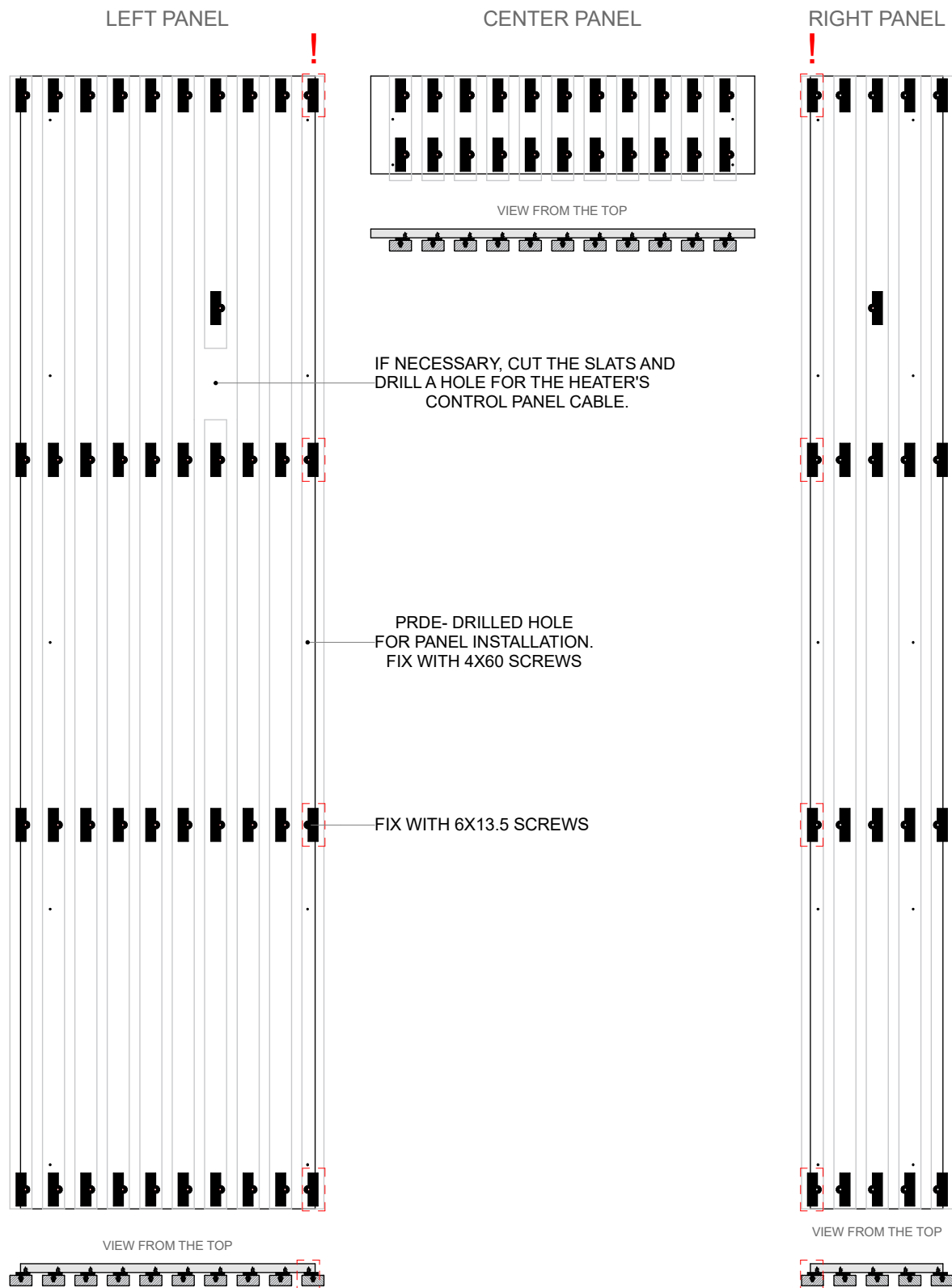

Door and Facade Panel Installation:

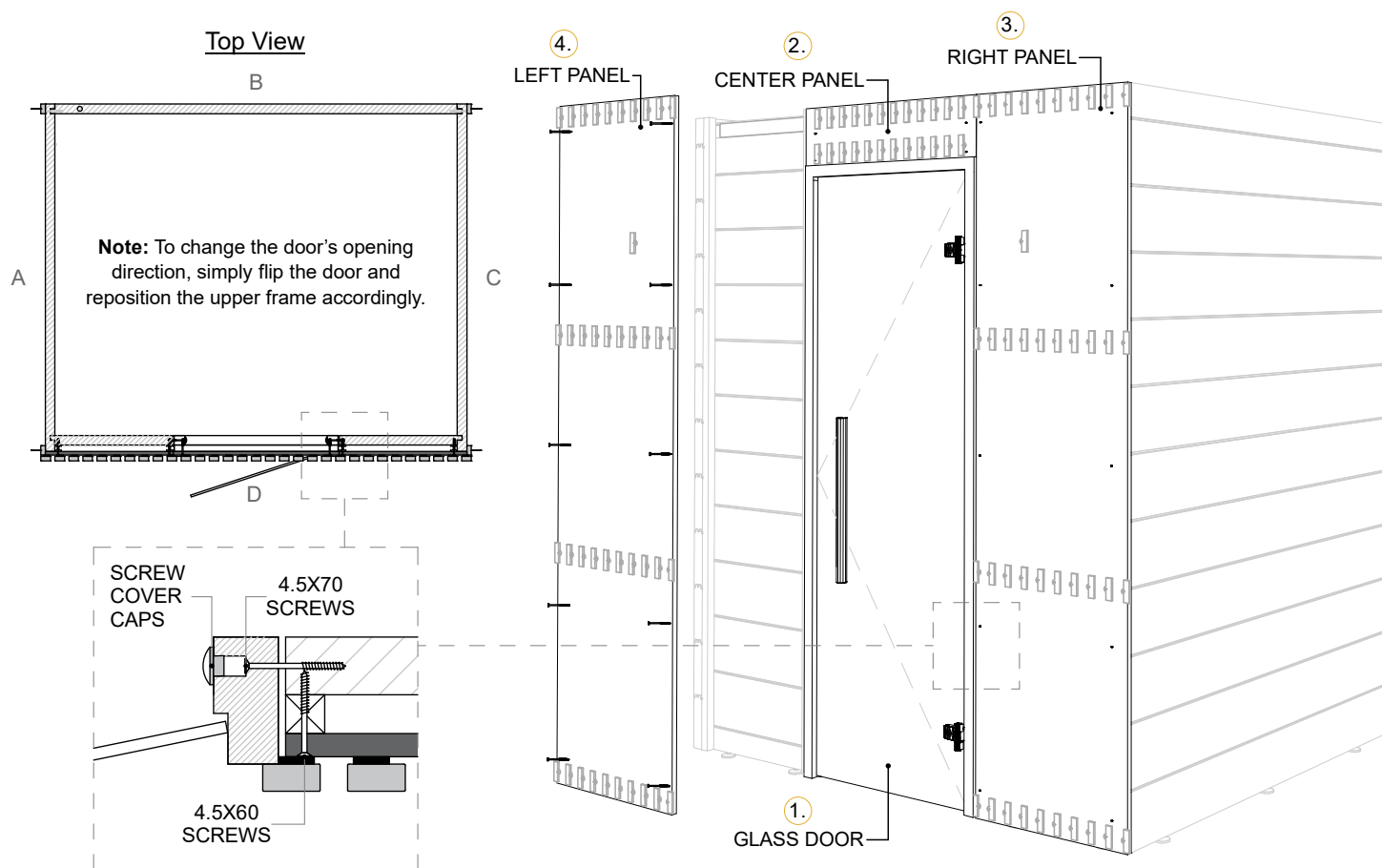

Decorative Slats:

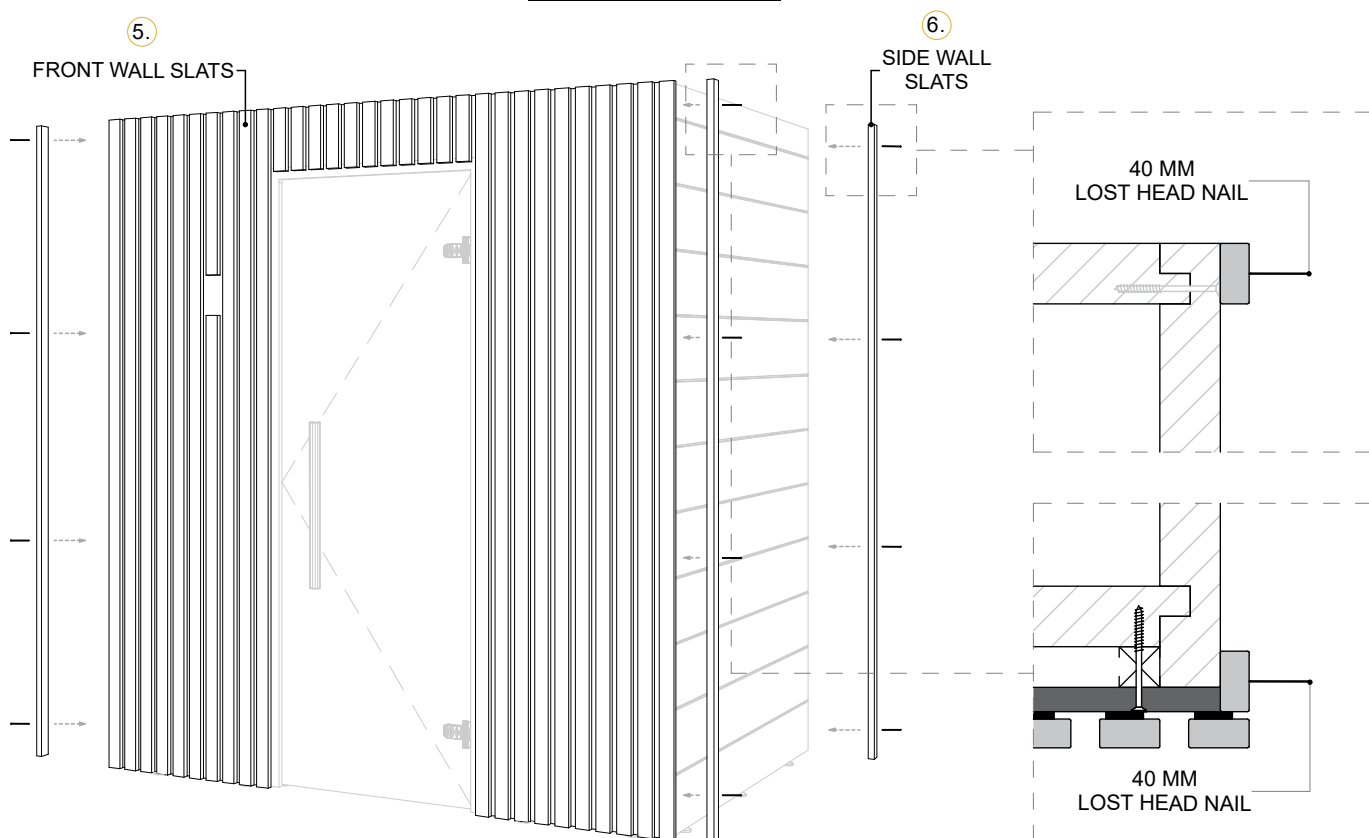

! Snap the decorative slats into place. Please note that they are not intended to be removed and reinstalled. In case of installation errors, four long and one short spare piece are included.

Back Wall Panel, Ventilation, and Bench Supports

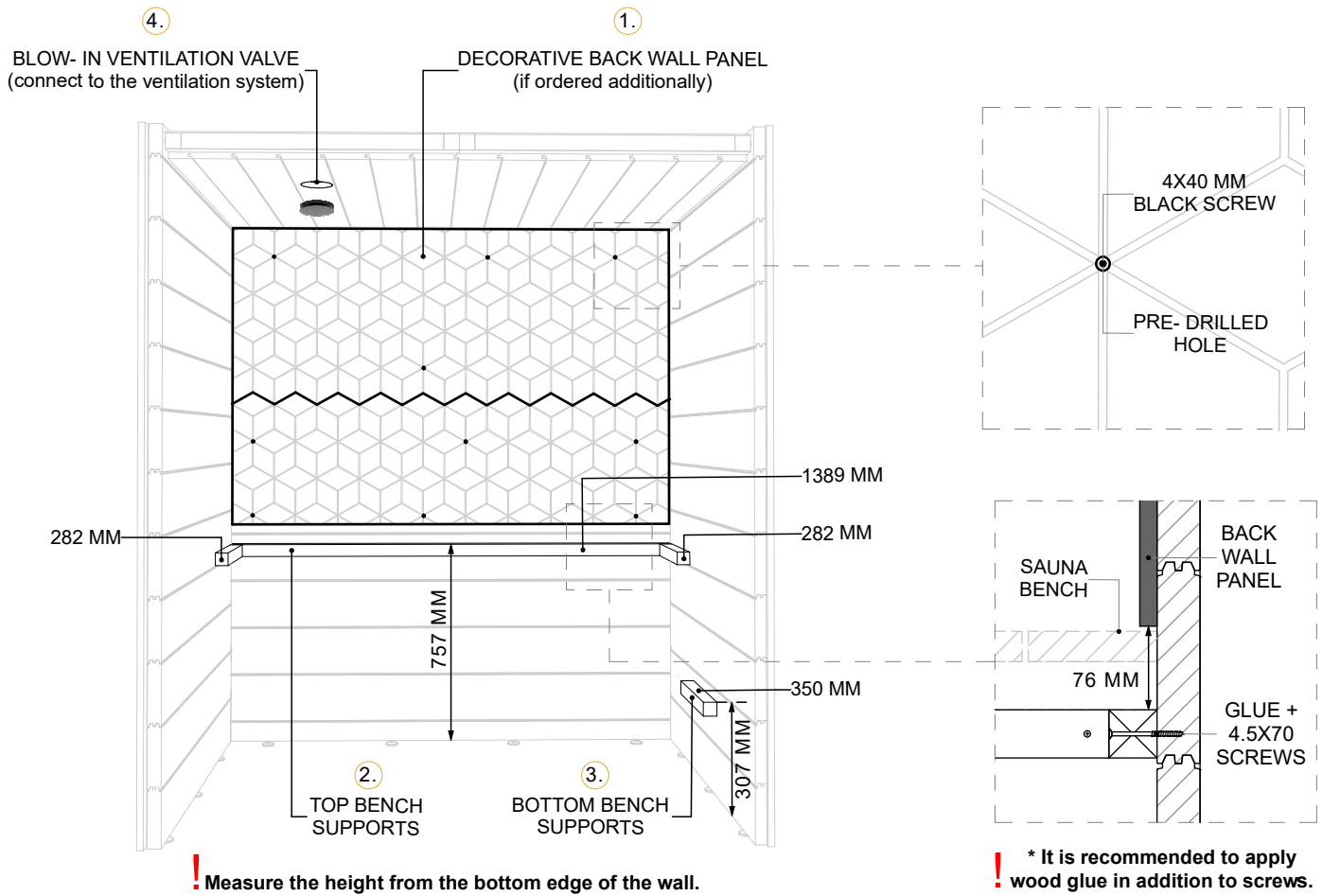

Sauna Benches and Moldings

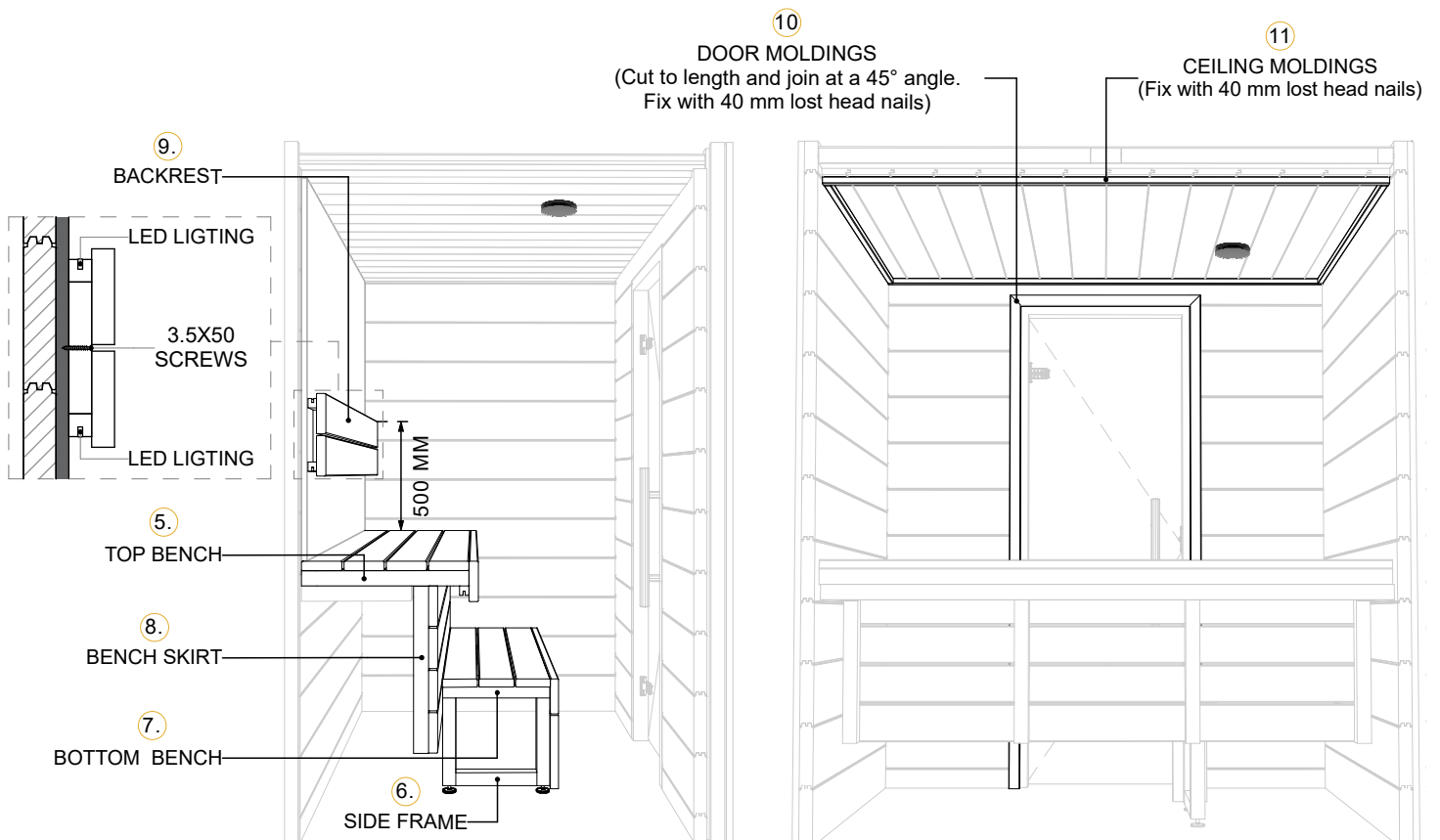

Safety Requirements and Maintenance

Safety Requirements for Indoor Sauna

Electrical Safety:

Only a certified electrician should install or service the sauna heater.

Use a properly grounded, sauna-rated power supply. Do not use extension cords or power strips.

Ventilation:

Ensure adequate ventilation to allow fresh air circulation and prevent overheating or humidity buildup.

Proper ventilation ensures a steady flow of fresh air, helps maintain a consistent temperature, removes excess humidity, and prevents mold or wood damage.

Heater Placement & Use:

Keep flammable materials (e.g. towels, paper, clothing) away from the heater.

Never cover the heater or place objects on it.

Follow the manufacturer's guidelines for sauna stone placement.

User Safety:

Limit sauna sessions to 15–20 minutes.

Stay hydrated and exit immediately if you feel dizzy, nauseated, or uncomfortable.

Children must be supervised at all times.

Pregnant individuals and people with heart conditions should consult a doctor before use.

Fire Safety:

Keep a smoke detector and fire extinguisher nearby (outside the sauna room).

Do not use candles or open flames inside the sauna.

Maintenance Guidelines for Indoor Sauna

After Use:

Leave the door open to allow moisture to escape and air to circulate.

Wipe down benches and walls with a damp cloth to remove sweat and residue.

Weekly inspect the heater and stones for cracks or displacement.

Clean the floor to remove dirt and debris.

Monthly check for signs of mold or mildew and clean with a mild sauna-safe disinfectant if needed.

Tighten screws and fittings if any parts have loosened.

Annually replace sauna stones if they are cracked or crumbling.

Have a licensed technician inspect the electrical components and heater performance.

General Tips:

Avoid harsh cleaners; use only non-toxic, sauna-safe products.

Use towels on benches to reduce sweat buildup and protect wood surfaces.

Re-oil or lightly sand wooden surfaces if they become dry or splintered (only with appropriate products).